



*Exterior Hinge
(4818228SSIPR)*

Product Description

The 4818228SS series Exterior Hinge is the perfect blend of strength and durability needed for exterior doors even in extreme weather conditions. Made from 100% stainless steel leaves, pin, caps and bearings, it offers magnificent resistance to rust and corrosion. The two fully stainless-steel ball-bearings reduce the friction and make opening heavy doors simple and smooth. The knurled ends of the pin and the cap prevent the pin from rising over time for a long lasting and silent operation.

▶ Features and Benefits

Material:

- Stainless steel (304): leaves, pins and caps
- Mild steel: balls and ball racers

Application

- Exterior (and also interior)

Type:

- Heavy-duty combination butt-hinge (frame-leaf rounded / door-leaf square)

Size:

- Width (open leaf): 4" (101.6 mm)
- Height: 4" (101.6 mm)
- Radius: 5/8" (15.9 mm)
- Gap: 1/8" (3.2 mm)
- Leaf thickness: .097" (2.5 mm)

Features:

- Load Capacity: 60 lb (27.2 kg) per 3 hinges
- Ball bearings (2)
- Mounting hole pattern: Zig-Zag ("W")
- Screws (included, 8 per hinge)
- Packaging: case with 100 hinges

Options:

- Removable pin
- Non-removable pin (NRP)
- Assembled (Left-handed / Right-handed)
- Non-assembled (KDS)



*Removable pin
with knurled end*

*Removable cap
with knurled stem*

Item Number	Pin	Assembly
4818228SS IPL	Removable	Left-Hand
4818228SS IPR	Removable	Right-Hand
4818228SS KDS	Removable	Unassembled
4818228SS NR IPL	Non-removable	Left-Hand
4818228SS NR IPR	Non-removable	Right-Hand
4818228SS NR PKDS	Non-removable	Unassembled

Dimensional Drawing

4818228SSNRPIPL shown

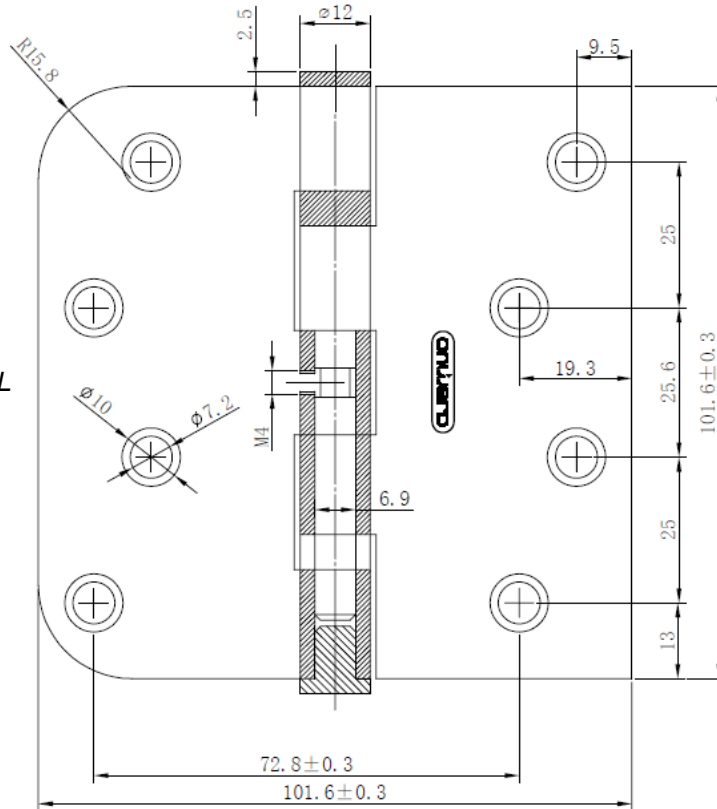

Screws

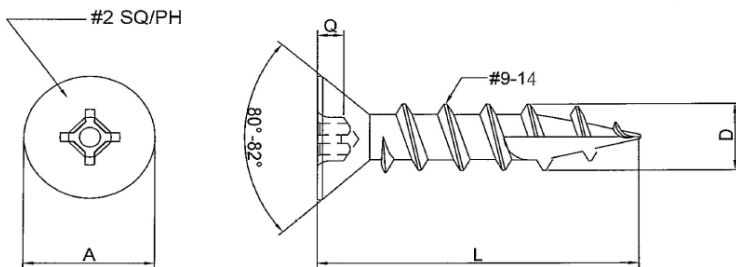

	A	Q	D
SIZE	HEAD DIA	RECESS DEPTH	MAJOR DIA
# 9	0.316-0.358	0.060-0.075	0.170-0.181

L (SCREW LENGTH)
0.750 +0/-0.03
1.125 +0/-0.03

Packaging

Each package contains:

- 100 hinges
(4 inner boxes of 25 hinges per box)
- 1 bag of 400 wood screws #9 x 3/4"
- 1 bag of 400 wood screws #9 x 1-1/8"
- 1 Allen-key (for removing set screws)

Each hinge comes with:

- 4 wood screws #9 x 3/4", flat-head, Quadrex drive, coarse full-thread, type-17 self tapping tip
- 4 wood screws #9 x 1-1/8", flat-head, Quadrex drive, coarse full-thread, type-17 self tapping tip